



Su Ürünleri İmalat İth. İht. Tic. Ltd. Şti.

Model	BARGE
Boy/Length	14900mm
Geniçlik/Width	12000mm
Yükseklik/h	7000mm
Kesim/Draft	1500mm
Ağırlık/Weight	100000kg
Yem kapasitesi/Feed Capacity	150000kg
Yemleme Sistemi/Feeding System	max.3x14 outputs
Silo	6 Pcs
Blower	3 Pcs
Tekne Tipi/Type	Feeding Barc



#### Accommodation;

- Control Room
- Kichen
- Resting Room
- Wc-Bathroom
- Divers Room
- Warehouse
- Bedroom for two stuff

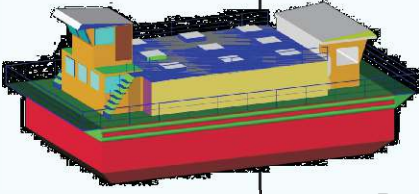

#### Construction: Profil and steel plates of 3701 quality

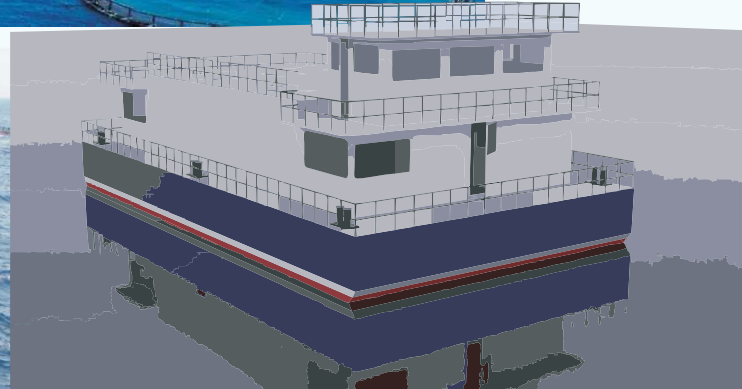
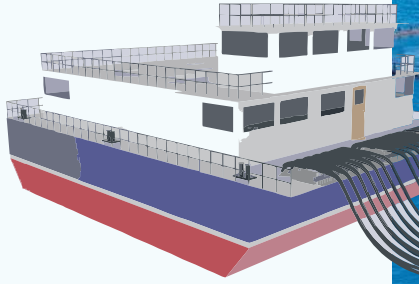

## FEEDING BARGE

There are types six or nine silos with a carrying capacity 130-150 tons of feed. In construction of our barge we use **profile and steel plates of 3701 quality. The barges are certified by CLASS SOCIETIES.**

The barges have four safety tanks. Further the barges are equipped with control room, engine room, diver's room, WC/shower, kitchens, living room, drinking water tank, sewage tank and F.O tanks.

The bottom and vertical are of the barges have five coat of paint, applied professionally.

Interiors are painted three coat of paints.

Engine room are equipped with engines approved by the client.

### Interior Materials

- \* 200 kw generator 1 pcs
- \* 70 kw generator 1 pcs
- \* No frost refrigerator 1 pcs
- \* Water heater 1 pcs
- \* Counter type kitchen stove 1 pcs
- \* 1200 BTU air condition 1 pcs
- \* 1800 BTU air condition 1 pcs
- \* 2400 BTU air condition 1 pcs
- \* Crom Water Tank 1 pcs
- \* Toilet and sink set 1 pcs
- \* Hydrophore 1 pcs
- \* Inox water pump 1 pcs
- \* Dining and living rooms interior layouts and their furnitures
- \* including electrical and water plump installations, Batteries, plugs and lambs
- \* all painting processes

